

VacMotion™

AUTOMATION FOR INDUSTRY

V-CV Series Vacuum Generators

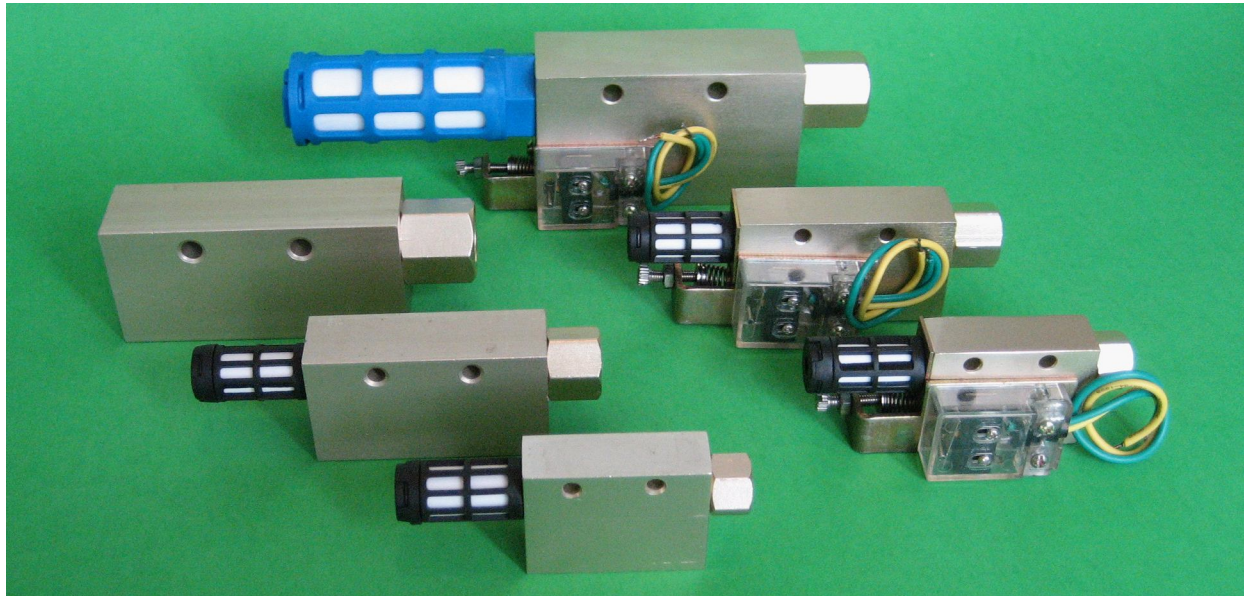

Application

The VacMotion V-CV Series is a maintenance free venturi vacuum generator ideally suited for all pick and place material handling applications. With a machined aluminum body, brass internal nozzles, and compact design, these vacuum pumps can be an economical and reliable choice for your material handling needs.

- Anodized aluminum body with nickel plated brass nozzle
- Vacuum levels to -27 inHg
- Vacuum flow rates from 0.95 to 3.88 SCFM
- All models supplied with exhaust silencer
- No moving parts make the units virtually maintenance free
- V-CV-CK with adjustable vacuum switch between 5.9" and 15.74"
- Switch accuracy +/- 1.6 inHg
- Hysteresis: 1.08" to 3.9"
- Circuit: Normally open
- Switch output: AC 125V/5A, AC 250V/3A, DC 250V/0.2A

| | |
|------------------------------|--|
| Media | Non-lubricated air, non-corrosive gases |
| Operating pressure | 14 to 114 PSI, optimum pressure 70 PSI |
| Operating temperature | 32 to 120F |
| Material | Body: Aluminum Nozzle: Nickel plated brass |
| Generator weight | V-CV10: 2.8oz; V-CV15: 4.9oz; V-CV20: 12.3oz V-CV10CK: 4.2oz; V-CV15CK: 6.7oz; V-CV20CK: 16.1oz |

VacMotion Inc. 34 Main St. Ext., Plymouth, MA 02360
Ph. 866-554-2877 Fax 508-747-1469 Web: www.vacmotion.com Email: sales@vacmotion.com

Evacuation time in sec/cu. ft to vacuum level (inHg) @ 70 PSI

| Model | Air Cons. SCFM | 3" | 6" | 9" | 12" | 15" | 18" | 21" | 24" | 27" |
|---------|----------------|-----|-----|----|------|------|------|------|-------|-------|
| V-CV-10 | 1.55 | 4.8 | 9.9 | 16 | 24.9 | 35.9 | 51.4 | 77.4 | 117.5 | 226 |
| V-CV-15 | 3.53 | 2.5 | 4.8 | 7 | 11 | 15.5 | 22 | 31.9 | 46.6 | 112.1 |
| V-CV-20 | 6.36 | 1.7 | 2.8 | 5 | 6.5 | 9 | 13 | 18.9 | 27.4 | 60.7 |

Vacuum flow at different vacuum levels (inHg) @ 70 PSI

| Model | 0" | 3" | 6" | 9" | 12" | 15" | 18" | 21" | 24" | 27" | 30" |
|---------|------|------|------|------|------|------|------|------|------|------|-----|
| V-CV-10 | 0.95 | 0.85 | 0.75 | 0.65 | 0.55 | 0.45 | 0.35 | 0.25 | 0.15 | 0.05 | 0 |
| V-CV-15 | 2.22 | 1.98 | 1.74 | 1.50 | 1.26 | 1.01 | 0.76 | 0.51 | 0.26 | 0.10 | 0 |
| V-CV-20 | 3.88 | 3.45 | 3.02 | 2.59 | 2.16 | 1.73 | 1.30 | 0.87 | 0.44 | 0.25 | 0 |

V-CV Series Basic Vacuum Generator

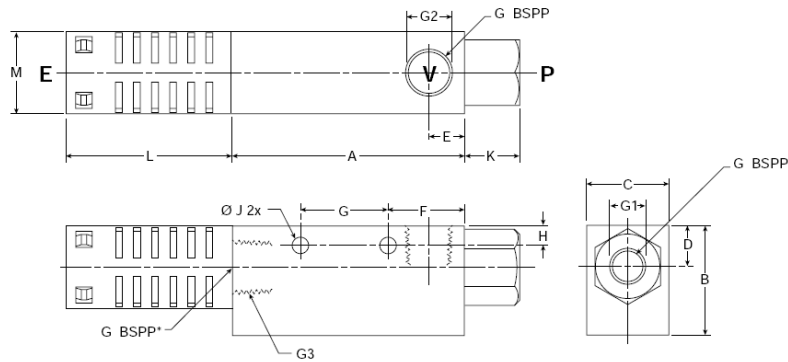

V-CV-CK Series with Mechanical Vacuum Switch

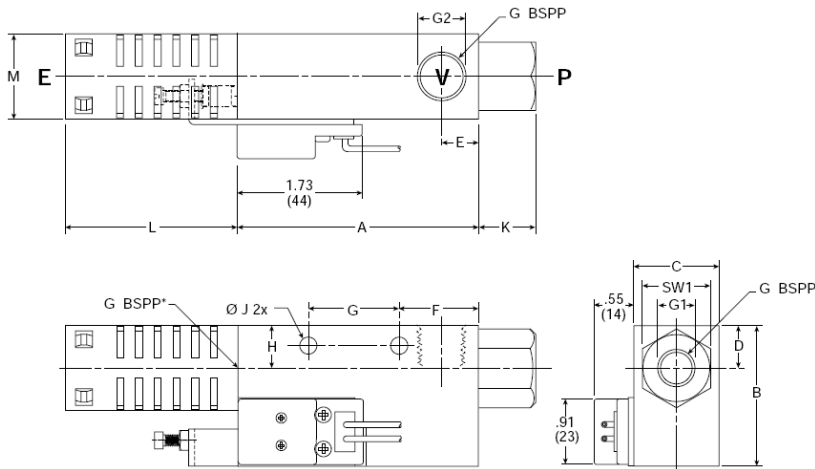

| Model | A | B | C | D | E | F | G | H | J | K | L | M | G1 | G2 | G3/SW1 |
|---------|----|----|----|----|----|----|----|-----|-----|----|------|------|------|------|-----------|
| V-CV-10 | 45 | 33 | 13 | 10 | 8 | 14 | 20 | 4.5 | 4.2 | 10 | 36 | 18.5 | 1/8" | 1/8" | 1/8" / 14 |
| V-CV-15 | 63 | 35 | 20 | 11 | 10 | 20 | 25 | 5 | 4.5 | 15 | 45.5 | 20 | 1/4" | 1/4" | 1/4" / 17 |
| V-CV-20 | 85 | 40 | 30 | 15 | 13 | 28 | 32 | 7 | 6 | 20 | 60.5 | 30 | 1/4" | 3/8" | 1/2" / 24 |

VacMotion Inc. 34 Main St. Ext., Plymouth, MA 02360

Ph. 866-554-2877 Fax 508-747-1469 Web: www.vacmotion.com Email: sales@vacmotion.com