

## SINGLE-STAGE VACUUM GENERATORS PVP 2 M

The vacuum generators described in this page are also based on the Venturi principle and share the same technical features as the previous ones. Their distinctive feature is their shape.

The vacuum connection U, in fact, is threaded to allow the assembly of a vacuum cup with a male 3/8" threaded gas support, while in-line, but on the opposite side an M 10 threaded hole allows installing the generator directly onto the machine or on the cup holders with springing device. They are fully made with anodised aluminium, with brass ejectors.

Equipped with a vacuum cup, they are true independent gripping units.

These vacuum generators are suited for vacuum cup operated loaders or handlers, for gripping sheet steel, glass slabs, plastic panels and other similar products.

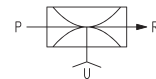
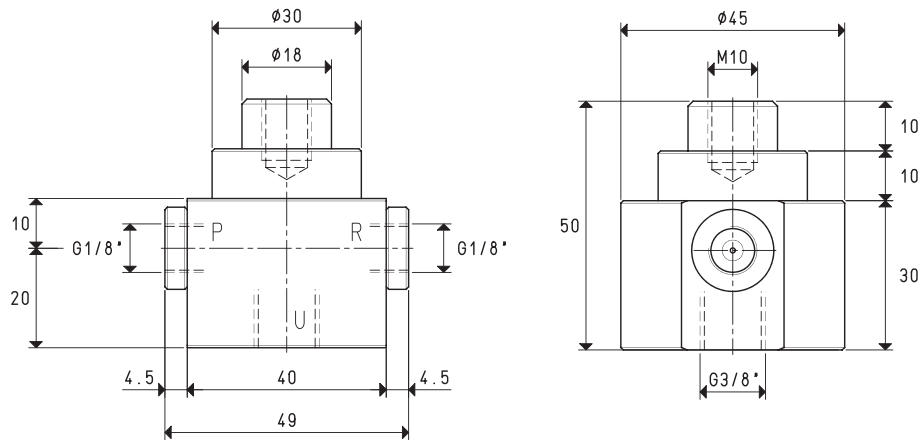

P=COMPRESSED AIR CONNECTION      R=EXHAUST      U=VACUUM CONNECTION

Art.	PVP 2 M		
Quantity of sucked air	cum/h	2.8	3.0
Max. vacuum level	-KPa	60	85
Final pressure	mbar abs.	400	150
Supply pressure	bar (g)	4	6
Air consumption	NI/s	0.7	1.0
Working temperature	°C		-20 / +80
Noise level	dB(A)		78
Weight	g		162

**Note:** All the vacuum data indicated in the table are valid at the normal atmospheric pressure of 1013 mbar and are obtained with a constant supply pressure.

8.20

Conversion ratio: inch =  $\frac{\text{mm}}{25.4}$ ; pounds =  $\frac{\text{g}}{453.6} = \frac{\text{Kg}}{0.4536}$

GAS-NPT thread adapters available at page 1.117



8



# SINGLE-STAGE VACUUM GENERATORS PVP 2 M

Air capacity (NI/s) at different vacuum levels (-Kpa)

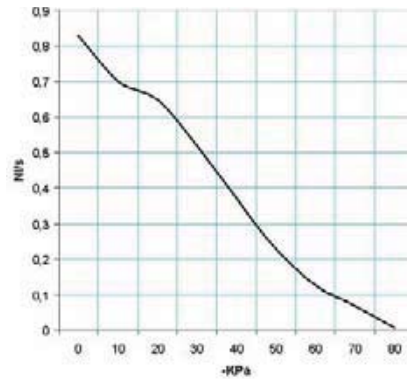

Generator art.	Supply press. bar (g)	Air consumption NI/s	Air capacity (NI/s) at different vacuum levels (-KPa)								Max. vacuum level -KPa	
			0	10	20	30	40	50	60	70		80
<b>PVP 2 M</b>	6.0	1.0	0.83	1.70	0.65	0.52	0.37	0.23	0.13	0.07	0.007	85

Evacuation time (ms/l=s/m<sup>3</sup>) at different vacuum levels (-Kpa)

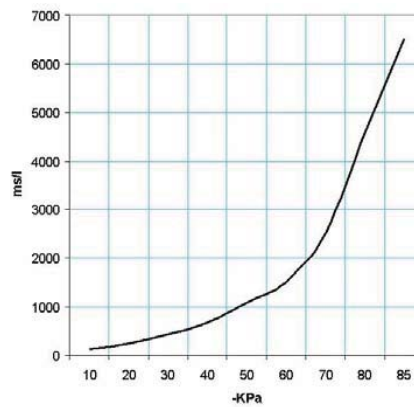

Generator art.	Supply press. bar (g)	Air consumption NI/s	Evacuation time (ms/l = s/m <sup>3</sup> ) at different vacuum levels (-KPa)								Max. vacuum level -KPa	
			10	20	30	40	50	60	70	80		85
<b>PVP 2 M</b>	6.0	1.0	128	257	438	675	1087	1511	2523	4572	6492	85

### Accessories upon request

Silencer art. 00 15 74

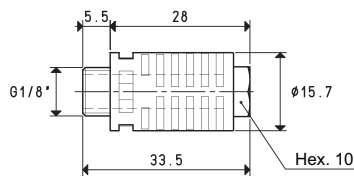

3D drawings available at [www.vuototecnica.net](http://www.vuototecnica.net)

